

Pamper yourself in Germany's only Glauber's salt thermal spa 2024



INFO-LINE: +49(0)2674-913070



There are places where you can easily leave the hustle and bustle of everyday life behind. Vulkaneifel thermal spa is one of these places, offering you a spa experience that is in a class of its own. Generous spa facilities with ample room to relax and unwind and enjoy the health-giving thermal waters of Germany's only Glauber's salt spring. It boasts more than 500 square metres of indoor and outdoor pool areas, including a hot tub and exercise pools. You can look forward to a uniquely spacious sauna landscape that has won an award from the German Sauna Association – including steam bath, and five themed saunas that guide you through the world of volcanism. There's a spacious sauna garden for cooling down, resting and recharging, including a library and a gallery. There's a wide choice of spa treatments available in our Vitalwelt health area. Whether classic or Far Eastern healing techniques, massages or body wraps, whether you come alone or with a partner – take a break and recharge your batteries today!



At a glance: A class of its own - three floors with ample room for relaxation and wellbeing.

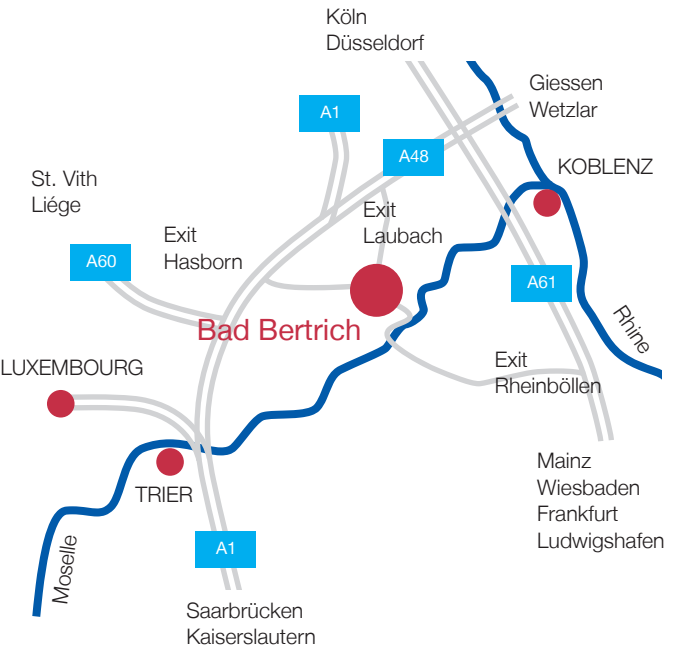
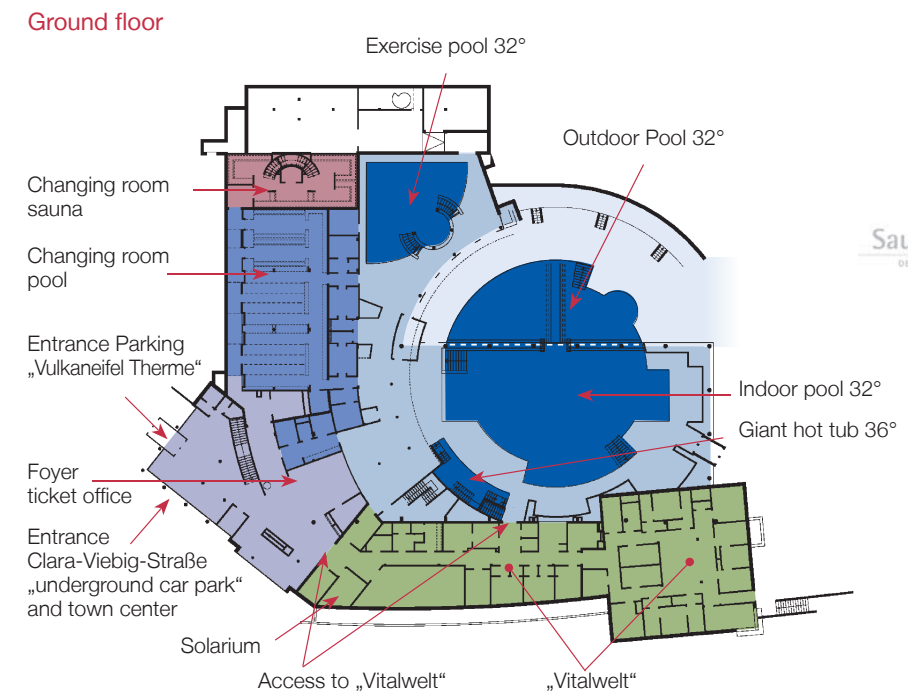

**P** **H**  
 You have two options: The parking lot „Vulkaneifel Therme“, make sure you don't miss the exit between Apollo and Diana tunnel. Or the car park across the Vulkaneifel Therme via Bad Bertrich's western exit.  
 Guests benefit from the following discounts:  
 2-, 3- or 4-hours tariff = 2 hours free parking.  
 Day pass= free parking

Staatsbad Bad Bertrich GmbH  
 Clara-Viebig-Straße 3-7, 56864 Bad Bertrich  
 Telefon 02674-913070, Fax 02674-9130747  
 info@vulkaneifeltherme.de  
 www.vulkaneifeltherme.de  
 Die Vitalquelle in Bad Bertrich



# A Spa with a great view indeed!



## Opening times

**Thermal Spa**  
Daily . . . . . 9.00am - 10.00pm

**Sauna**  
Monday - Thursday . . . . . 11.00am - 10.00pm  
Friday - Sunday,  
Public holidays . . . . . 9.00am - 10.00pm

**Therapy and wellness area**  
Monday - Friday . . . . . 9.00am - 8.00pm  
Saturday . . . . . 9.00am - 6.00pm  
Sunday, public holidays . . . . . 10.00am - 6.00pm

**Solariums**  
Ergoline Inspiration 450 S Twin-Power  
5 min €3,00 . . . . . each additional minute €0,60  
Ergoline Balance 600  
5 min €3,00 . . . . . each additional minute €0,60  
There is one solarium in the foyer, and two more in the Thermal Spa area.

**Café & Thermen Bistro**  
montags - freitags . . . . . 10.00am - 9.00pm  
Küche werktags . . . . . 12.00 - 8.00pm  
sonntags, feiertags . . . . . 11.30am - 8.00pm

**Ticket office closing time and last admission**  
1 hour before closing time. The spa area must be vacated 20 minutes before closing time; new Christmas and New Year opening times. **Closed for maintenance from 17 to 30 June.**

**Hire fees for**  
bathrobes . . . . . € 5,00  
towels . . . . . € 3,00  
sauna towel . . . . . € 3,50  
blankets . . . . . € 3,00

For health and safety reason, children must be 3 years old to be admitted to the spa. Young people under the age of 14 must be accompanied by an adult.

Birthdays guests receive free admission on their birthday (proof of identity required).

## Admission Charges Thermal Spa & Sauna

**Adults**  
2 hours . . . . . €11,00 . . . . . € 20,00  
3 hours . . . . . €12,50  
4 hours . . . . . €14,00  
Day pass\* . . . . . €15,50 . . . . . € 25,00

**With visitor's card or 80 % disability**  
3 hours . . . . . €11,00 . . . . . € 20,00  
4 hours . . . . . €12,50  
Day pass\* . . . . . €14,00 . . . . . € 25,00

**Children from 3 to 16 years**  
2 hours . . . . . € 8,00 . . . . . € 16,00  
3 hours . . . . . € 9,00  
4 hours . . . . . €10,00  
Day pass\* . . . . . € 11,00 . . . . . € 20,00

**Family ticket 1\*\* (1 adult, 1 child)**  
2 hours . . . . . €18,50 . . . . . € 35,00  
3 hours . . . . . €20,50  
4 hours . . . . . €22,50  
Day pass\* . . . . . €24,50 . . . . . € 43,00

**Family ticket 2\*\* (2 adults, 1 child)**  
2 hours . . . . . €28,50 . . . . . € 53,00  
3 hours . . . . . €31,50  
4 hours . . . . . €34,50  
Day pass\* . . . . . €37,50 . . . . . € 65,00

**Multiple entry pass (10 visits)**  
2 hours . . . . . €105,00 . . . . . € 190,00  
3 hours . . . . . €118,00  
4 hours . . . . . €127,00  
Day pass\* . . . . . €140,00 . . . . . € 240,00

**Prepaid pass\*\*\***  
5 % discount . . . . . € 50,00  
10 % discount . . . . . € 100,00  
15 % discount . . . . . € 250,00

\* Uninterrupted stay  
\*\* € 6,50 for each additional family member up to age 16  
\*\*\* Plus deposit of € 5 only valid for adults' hourly and day passes Spa & Sauna and Solariums



**YOU CAN FIND MORE INFORMATION ON ALL TREATMENTS IN OUR BROCHURE OR ON THE INTERNET: WWW.VULKANEIFELTHERME.DE**

How would you like us to pamper you today? Aqua aerobics? Fango? A classic massage? Thai massage? Grape seed oil massage? Hot stone massage? You name it – we have it. Here, the top grape-based treatments meet the best from our Eifel region, combining with traditional classic treatments to offer you the most exotic pampering. The Vulkaneifel Thermal Spa world of health is sure to exceed your expectations. So why not book a whole day of wellbeing for yourself? Relax and unwind in a place that exudes warmth and tranquillity. Leave the hustle and bustle of everyday life behind and enjoy the deep relaxation effects of our full-day programmes which include an impressive range of services. All full-day programmes can be pre-booked on +49(0)2674-9130713 (from Monday through Friday, 9.00am - 18.00pm). And you can also book all of the programmes at our online shop [www.vulkaneifeltherme.de](http://www.vulkaneifeltherme.de).

**T** Traitements Thérapeutiques **W** Traitements de spa

## Sauna treatments W

Foamy soap brushing\* approx. 30 min . . . € 42,00  
Vulkan-Natur-Fango (mudpack)  
foamy soap brushing\* approx. 30 min . . . € 42,00  
\*Foamy soap brushing is only possible with the combi-ticket „Thermal Spa and Saunas“.

## Treatments using thermal mineral water T

Aqua aerobics  
Group treatment per person . . . . . € 19,50  
individual treatment . . . . . € 33,00

All treatment times include the post-treatment relaxation period.

For all cancellations that are made with less than 24 hours notice, a 50% cancellation fee will be charged. Reservations that are not cancelled in advance will be charged in the full amount (100%).

# Our treatments: beneficial, healthy and preventive.

## Far Eastern healing techniques W

Master Thai-massage . . . . . € 72,00  
approx. 60 min . . . . . € 72,00  
Nuad Thai - Traditional Thai treatment . . . . . € 72,00  
approx. 60 min . . . . . € 72,00  
Nuad Thai – Thai foot massage  
approx. 60 min . . . . . € 72,00  
Thai essential oil massage  
approx. 60 min . . . . . € 72,00  
Dien Cham & Cinan - Vietnamese face  
reflexology treatment including reharmonising  
massage approx. 30 min . . . . . € 42,00

## Spa & wellness treatments W

Hot stone massage approx. 30 min . . . . . € 45,00  
ca. 60 min . . . . . € 75,00  
Cold stone massage approx. 30 min . . . . . € 45,00  
Herb pistil massage approx. 30 min . . . . . € 60,00  
ca. 60 min . . . . . € 90,00  
Candle light massage approx. 30 min . . . . . € 41,00  
Harmony massage approx. 30 min . . . . . € 35,00  
ca. 60 min . . . . . € 60,00  
Rose petal bath approx. 30 min (1 person) . . . € 35,00  
approx. 30 min (2 persons) . . . . . € 58,00  
Sparkling wine bath  
approx. 30 min (1 person) . . . . . € 35,00  
approx. 30 min (2 persons) . . . . . € 58,00  
Rose dream approx. 60 min . . . . . € 70,00  
Time for two approx. 90 min . . . . . € 85,00  
Full body polish using sea salt  
approx. 30 min . . . . . € 38,00  
Sea salt & milk bath approx. 30 min . . . . . € 36,00

## Massages T

Volcano-Nature-Fango approx. 20 min . . . € 32,00  
Classic massage approx. 20 min., . . . . . € 27,00  
approx. 30 min., relaxing . . . . . € 35,00  
Breuss massage approx. 30 min . . . . . € 37,00  
Dorn Breuss combination approx. 60 min. € 70,00  
Lymphatic drainage approx. 30 min . . . . . € 36,00  
approx. 45 min . . . . . € 48,00  
approx. 60 min . . . . . € 60,00  
Foot reflexology 30 min . . . . . € 35,00  
Head relaxing massage  
approx. 30 min . . . . . € 35,00

## Joint treatments T

Dorn method approx. 30 min . . . . . € 37,00  
NST- Neurostructural Integration  
Technique approx. 50 min . . . . . € 64,00

**BOOK YOUR HEALTH AND SPA APPOINTMENTS ON TEL: +49(0)2674-9130713 (MONDAY TO FRIDAY FROM 9AM TO 6PM) OR ONLINE AT WWW.VULKANEIFELTHERME.DE**

Full body massage using  
body and bath oils approx. 30 min . . . . . € 35,00  
Sea salt foot bath and foot massage  
using sea salt foot lotion approx. 40 min. . . € 44,00  
SanVino grape seed oil massage app. 20 min € 30,00  
approx. 30 min. . . . . € 40,00  
approx. 50 min. . . . . € 58,00  
SanVino leg & foot massage app. 30 min . . . € 35,00  
SanVino body anointing approx. 30 min. . . . € 45,00  
SanVino grape seed body peeling  
+ full body massage approx. 50 min. . . . . € 78,00  
SanVino grape seed body peeling  
+ cream compress  
+ full body massage approx. 80 min. . . . . € 105,00  
SanVino grape seed body  
peeling approx. 30 min. . . . . € 45,00  
SanVino facial treatment approx. 30 min. . . . € 52,00  
Men treatment approx. 30 min. . . . . € 52,00

## Daily programmes

Relaxation day for men . . . . . € 92,00  
Intensive relaxation day . . . . . € 145,00  
Day with grapes . . . . . € 102,00  
Far Eastern day . . . . . € 98,00  
Relax-Tag . . . . . € 92,00  
Gesundland-Tag . . . . . € 63,00  
Wellness 1 . . . . . € 38,50  
Wellness 2 . . . . . € 48,00  
Wellness 3 . . . . . € 86,00  
Wellness 4 . . . . . € 114,00  
Wellness 5 . . . . . € 62,00

## Yummy! How delicious!

Spending from € 5.00 on food & drink in the Café & Thermen Bistro of Vulkaneifel Thermal Spa entitles you to an additional hour of spa use.

## Ooh! What a treat!

Aqua aerobics under guidance Mon - Fri 9.30am and 1.30pm, Sat 9.30am

